



SHIRKE
ELECTRO PVT.LTD.

SWITCH TO **RELIABILITY**



BREAKER CONTROL SWITCHES

Breaker Control Switches are used in MV, HV & UHV Breakers. They are used as Selector Switches for controlling Locally or Remotely. They are used to Trip or Close the Breakers with momentary contacts



Pistol grip & Wing type
Lockable handles available
for security & safety

Silver alloy contacts used,
have very high durability
& endurance.

Cams used for contacting make
it suitable for switching in various
programmable combinations.

A double break contact ensures
positive making & breaking.

Superior insulating material
ensures electrical & mechanical
stability.

Modular design to achieve any
number of poles with minimum
components.

BREAKER CONTROL SWITCHES



Construction

Rotary Cam Switches are modular in design with contact housing stacked with indexing mechanism. The operating knob is attached to steel shaft that rotates the cams which drive the contacts to an unlimited combinations of contact programmes. The housing is made of engineering thermoplastic material contains two sets of contacts. The contacts are mechanically opened & are closed using springs that provide force to achieve desirable contact pressure. Two poles can be arranged in each set of contact housing making it compact for the application.

Specifications

Conventional free air thermal current (I _{th})	25A	32A	40A
Rated operational voltage (U _e) a.c.	440 V	440 V	440 V
Rated operational current (I _e) a.c.	25A	32A	40A
Rated operational current (I _e) d.c.	2A	2A	2A
Utilization category	AC- 23A, DC-23A	AC- 23A, DC-23A	AC- 23A, DC-23A
Dielectric strength	2.5 kV	2.5 kV	2.5 kV
Rated impulse withstand voltage (U _{imp})	3 kV	3 kV	4 kV
Insulation resistance	≥ 500 MΩ	≥ 500 MΩ	≥ 500 MΩ
Universal 4 Hole mounting for Finger protection (mm)	M5- 48.0 CTC	M5- 48.0 CTC	M5- 48.0 CTC
Universal 4 Hole mounting for open terminal (mm)	M5- 49.5 CTC	M5- 49.5 CTC	M5- 48.0 CTC
Front Plate dimensions (mm)	75 x 75 mm 90 x 90 mm	75 x 75 mm 90 x 90 mm	75 x 75 mm 90 x 90 mm
Mechanical life (Operations)	3,00,000	3,00,000	3,00,000
Electrical life (Operations)	1,00,000	1,00,000	1,00,000
Conforms to standard IS / IEC - 60947- 3			

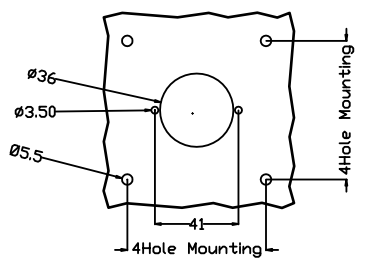

PANEL CUTOUT FOR
KEY LOCK ACCESSORIES

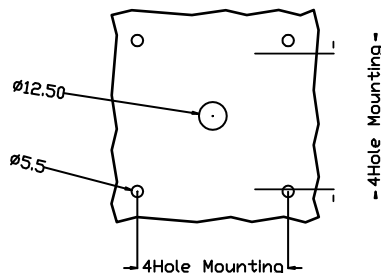

PANEL CUTOUT

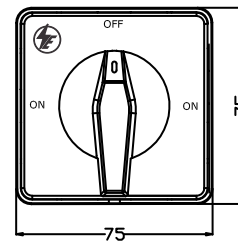

TOP VIEW

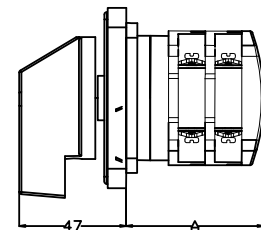

SIDE VIEW



SHIRKE
ELECTRO PVT.LTD.
ISO 9001:2015 company

Corporate office & Plant I
L-25 MIDC Ambad, Nashik,
Maharashtra, India, 422010
Ph.: +91 253 6619372, 2384672

Plant II
W 72A, MIDC, Ambad, Nashik
Maharashtra, India, 422010
Ph.: +91 253 6600372

sales@shirkeswitch.net
www.shirkeswitch.net